

SAN JUAN COLLEGE
Success Matters



Totah
Archaeological
Project (TAP)
Field School,
New Mexico
2023

San Juan College,
4601 College Blvd., Farmington,
NM 87402

Introduction

Background

The Totah Archaeological Project (TAP) field school offers two courses through San Juan College (SJC) in Farmington, New Mexico. The **ANTH 2120 Archaeological Field Methods** and **ANTH 2998 Archaeology Internship** courses provide an opportunity for students to excavate and survey on the private 12,461-acre B-Square Ranch owned by Tommy Bolack. The Ranch is situated on the south side of the San Juan River in Farmington, New Mexico. The goal of the field school and internship is to prepare students for archaeological excavation, survey, and laboratory research in either an academic or cultural resource management setting. They also can visit some amazing archaeological sites here in the Southwest region. In this document, prospective student will find the information needed to decide if the field school aligns with their career and academic pursuits.

Instructor and Contact Information

Linda Wheelbarger (wheelbarger@sanjuancollege.edu) has directed the TAP field school from its inception in 1999. Wheelbarger was co-director of the SJC Cultural Resources Management Program, a contract archaeology office, for 20 years. She retired from that position in 2010 but continues teaching the field school and is very active professionally in the Four Corners archaeological world, having worked here for 45 years, 37 of them at SJC. Following the field school, Wheelbarger regularly attends the annual Pecos Conference held for professional and avocational archaeologists of the American Southwest. Students are encouraged to attend and if they wish, can participate through presentations or posters. This year the conference is being held in Flagstaff, AZ from August 10-13th. Information is on-line at pecosconference.org.

Tuition, Registration, and Course Requirements

This summer, the six-week field school session runs from June 5th to July 14th, 2023, which includes four weeks of field work followed by two weeks of laboratory work. As San Juan College is a community college, all classes are undergraduate level only. Field school participants will be limited to 20 individuals. The Archaeological Field Methods class, ANTH 2120, is 6 hours of undergraduate-level Humanities credit. The ANTH 2998 Archaeology Internship is 3 hours of undergraduate-level Humanities credit. Each student may register for one or both classes resulting in a total of 3, 6, or 9 total credits. There is no formal application process beyond registering with San Juan College and contacting Wheelbarger for permission to register. If potential registrations surpass 20 individuals, then a waiting list will be created wherein students will be moved into the program if and when room becomes available. You must let Wheelbarger know if you change your decision to attend our field school.

The Summer 2023 tuition rates are as follows:

New Mexico Resident – \$56/credit hour

Plus:

Either: A flat fee of \$77.50 for resident students taking the 3 credit class
Or: A flat fee of \$185.00 for resident students taking the 6 credit class or both classes
And \$1.50 student activity fee per credit hour

Non-Resident – \$178/credit hour

Plus:

Either: A flat fee of \$137.50 for non-resident students taking the 3 credit class
Or: A flat fee of \$305.00 for non-resident students taking 6 or 9 credits
And \$1.50 student activity fee per credit hour

In addition, all summer field school and intern students must pay an Equipment and Supply fee to help cover equipment, vehicle rental, supplies, and other miscellaneous costs. The Equipment and Supply fee is \$100 per 3 course credits. The fee for the 6-credit Field School is \$200, the fee for the 3-credit Internship is \$100 and if a student wants to sign up for both courses to receive 9 credits, the total fee is \$300.

Total tuition costs for the summer field school/internship classes including credit hour fee, flat fee, activity fee, and Equipment and Supply fee are:

New Mexico Residents

3 credit class = \$350.00

6 credit class = \$730.00

Both classes for 9 credits = \$1002.50

Non-New Mexico Residents

3 credit class = \$776.00

6 credit class = \$1,582.00

Both classes for 9 credits = \$2,220.50

For students taking the course for a grade, the following attendance is required:

- 3 credit students are required to stay any two weeks or any 10 days
 - 6 credit students are required to stay any four weeks or any 20 days
 - 9 credit students (taking both classes) are required to stay all six weeks (all 30 days)
-

TAP Course Grading

All students will be graded on field and lab participation, work performance, and compilation of an excavation summary report. The ANTH 2120 students will also be required to take a final exam covering excavation and survey procedures, artifacts, knowledge of Southwest cultures, and laws. The exam will be given to those students who are required to take it on their last day of attendance.

Excavation activities include assignment of a dig partner and dig kit to use during excavation, review of the Excavation Manual, instruction on how to fill out associated paperwork, instruction on excavation techniques and use of assigned tools, and procedures for finalizing paperwork, artifacts, and other procedures for excavation levels.

Activities within the two lab weeks includes completion of any additional washing of artifacts or processing of ecofacts and samples, placing collections in appropriate curation bags or other materials with provenience, organization of all artifacts into banker's boxes with catalogs of enclosed materials, tabulation and entering artifact and provenience data into spreadsheets, editing of the spreadsheet data, production of artifact tables by provenience, drafting maps, scanning excavation forms, organizing all forms within the log book, and photographing decorated ceramics, projectile points, tools, and special or exotic items. In addition, students will help write-up the excavation notes from all field forms and organize field photos by area. One excavation day and one survey day are scheduled within the final two weeks of lab so students who only come to the lab weeks will still get some excavation and survey experience.

As to the assigned excavation report, the report parts cannot be provided to students until after the two lab weeks are completed. Photos, artifact tables, maps, and excavation unit remarks will be emailed to students along with report examples if they have not already received one. Reports need to be compiled at their home or wherever they happen to be located after the end of field school.

Students will be assigned specific excavation areas to be summarized in their reports. Assigned excavation summary reports will vary in size based on the class or classes students are taking for credit. As an example, an ANTH 2998 report would be approximately 10 pages, an ANTH 2120 report would be approximately 20 pages, and the report for a student taking both classes would be approximately 30 pages. The reports sound intimidating, however, all materials for the reports are provided to the students and they just need to organize them into the specific site areas that they are being required to summarize. Introductory materials for the reports will be provided to them by Wheelbarger who will also provide them with report examples. In general, students are assigned the area or areas of the site they excavated. If they happen to be a student only attending lab, then they will be assigned one or more areas from the 2023 excavation. Completed reports must be emailed to wheelbarger as a word document or pdf.

There is flexibility on when students must submit reports to Wheelbarger. Proposed dates for a draft report and final report are shown in the calendar schedule at the end of this document and before the site maps. However, students can turn in reports at any time after they have received their materials. After review of their draft report, students will have more time to produce a final version of the report only if necessary. Wheelbarger will review and finalize each student's grade as the reports are received in order for students to be able to transfer credits as quickly as they wish. All reports must be received by the time grades are due in the Registrar's Office by Monday, August 14th, at 10am MST.

All students are welcome to stay for the entire 6-week session if they so desire whether they are taking the course for a grade or are auditing the class for no grade. People interested in attending the field school as a volunteer should sign up to Audit the ANTH 2998 Internship course and thus can attend any part of the session but are not responsible for any course requirements. Students who have previously taken and paid for the field school or internship, whether they were auditing or taking it for a grade, are permitted to volunteer with no fees required.

Admission to San Juan College

Unless you are a currently attending SJC student, registration does not begin until mid-April of 2023. However, all students interested in attending the field school should go ahead and **Apply for Admission** to SJC as soon as possible at no charge. You can be admitted on-line at SJC's web page: www.sanjuancollege.edu. Hover your cursor over the **Admissions and Aid** tab on the left, then move down and click on the **How to Apply** tab. Step 1 is to identify your Admission Type. Unless you are a San Juan College student, you will be registering as **Non-degree seeking** students. That is because you will be transferring your credits to the school you are attending. **As long as you are NOT planning on continuing at SJC, you do not need to send any transcripts, do not need to take the Accuplacer test, and do not need to go to an orientation. For you Non-degree seeking students:**

- 1) Go to Step 2 where you will Create an Admissions Account
- 2) After clicking on the Create Account Tab
 - a. Fill in your personal details
 - b. Choose Summer Term
 - c. Choose Non-Degree as Admit Type
 - d. Under the Academic Program choose the second choice which is ND or Non-Degree seeking
 - e. Create and Confirm a Password

Once you are admitted, you will be provided with an SJC e-mail address. This is extremely important because you will be using your SJC email address to register for the course you choose to take. **Wheelbarger's permission is required to register for the field school and internship courses. That means that if you try to register on-line, the system will not let you!!!**

Once registration has begun for non-degree seeking students in mid-April 2023, you will need to email Wheelbarger (see her contact information), USING YOUR ASSIGNED SJC E-MAIL, requesting permission to register stating the class or classes you want and whether you want to take the class for a grade to receive credits or you want to Audit. Wheelbarger will respond to your request replying to both you and the Registrar, with permission for you to be registered. Once the registration office has processed the request, you will be sent an email telling you that you are registered for the class. Usually, this response is that same day, but if they are very busy it may take a couple days. You will be dropped from registration if you do not pay by the time mentioned on the web page. If that happens, it is a relatively simple matter for you to request permission again, but at that time you will probably be required to pay immediately (that same day or within a few days) for the course, so do not request that second registration until you are prepared to do so.

TAP Room and Board Information

Lodging and Food

Room and board are the responsibility of the student, however, for the last 10 years or so, Wheelbarger made an arrangement for non-local students to stay at the Economy Inn in downtown Farmington where special rates are given to the students. The Economy Inn is not a fancy motel! She chose it for its affordability and its location in small downtown Farmington within walking distance to restaurants and stores. Also, it is on her way to the Ranch so she can pick up students easily if necessary. It has worked out quite well all these years and the Economy Inn will continue to provide special rates. The motel is located only two blocks from the excellent Three Rivers Brewery and Café. For those who are of drinking age, the beer is excellent, and the Nachos are magnificent!! When two students share a room with two beds, each will pay \$125 per week. There are a few rooms with kitchens, which cost somewhat more. One is larger and can handle up to four students and the others are smaller and are suitable for only 1-2 students. All rooms without kitchens have a microwave and small refrigerator. Of course, students who prefer are welcome to have a room by themselves at a higher cost. A single room rate for 1 person/1 bed is \$240 per week or \$250 for 2 people/2 beds. Several students have stayed at the *Brentwood Inn* where the cost is a little higher per week, but they offer breakfast and have a swimming pool. It is also on the way to the field so you can easily be picked up and dropped off by Wheelbarger. Food costs are dependent on the student, but \$100 per week is a good, although very minimal, estimate.

If you want to “do your own thing”, that is absolutely fine and you should check out the Farmington New Mexico Convention and Visitors Bureau’s web page that has lots of information on the area (www.farmingtonnm.org) where they have more information on where to stay. I would say that the students all greatly enjoyed staying together. Field schools are normally a great “group bonding” experience.

If you really need to save money, camping is possible, but relatively limited in Farmington. If you have an RV that you would like to use, there are several RV Parks available – check the Convention and Visitors Bureau web page. That option is usually not cheaper than the Economy Inn, but you may want to do that if you want more privacy. If you are truly camping to save money, the only place in Farmington is at Farmington Lake where the price is \$5 per night plus a 1\$ daily access fee (see the CVB web page under Where to Stay/Camping). Another option is to camp for free on public domain, Bureau of Land Management (BLM) land. The Farmington Glade and the Head Canyon area are mentioned on the CVB web page, but Pinon Mesa (which Wheelbarger can show you) is also a very nice option. These are all close to Farmington. Of course, to do this you must have your own vehicle to camp out of and you will have to drive back and forth. Also, there will be no water or bathroom facilities and you probably should not leave any stuff out there during the day, but this option is possible. If you can find a nice hidden place, you might be able to leave your tent up.

Vehicles

Until it gets close, it is difficult to know how many students are going to have cars. Wheelbarger normally picks up and drops off students at the Economy Inn, or other places, as necessary. When there are other students with cars, as gas is so expensive, those of you who consistently ride with another student please be sure and help them

with gas money. Fortunately, everything is close, and we will not be driving far except on our field trip days. Depending on the number of students who go on the field trips, we may have to count on one or more people to help with driving. Thank you in advance for that!!

Flying

As students register, you will need to let us know what your plans are, driving in? flying in? etc. If you do plan on flying, the closest airport is Durango, CO (DRO) and Wheelbarger has always picked up students from there. It is cheaper to fly into Albuquerque (ABQ), but then it is almost 200 miles to get up here to Farmington. There is no bus, and the shuttle is very expensive. I just checked and it is \$239 one-way, wow! Or you could check on renting a vehicle at the airport. I believe there is a bus that arrives in Durango, CO, so if you come that way, again, Wheelbarger will come get you there.

Weather and Work Schedule

Our Farmington weather is usually hot and dry, 90-100 degrees Fahrenheit, with occasional brief rain showers in the summer. Some years we have about a week of 100–103-degree Fahrenheit weather, although we have not for the last several years. The site is in an open area where we frequently get wonderful breezes. We use EZ-Up shade shelters over the excavation areas where we also compile excavation records and bag artifacts. For those of you staying at the Economy Inn, or elsewhere, you will be picked up at 8:10am or you can drive out to the Ranch where we have a designated meeting area. We try to take as few vehicles out to the site as possible. We leave for the site from where we park at the Ranch at 8:30am. The road to the site is rough, so only those with appropriate vehicles can drive. Mornings go quickly and we take a late 1pm lunch down by the river under the cottonwoods, a short distance from the site. We take 45 minutes for lunch and thus only have 2 hours of work in the more intense afternoon heat before we call “clean up” at 3:45pm. It takes about 15-20 minutes to clean up and another 15-20 minutes to caravan back to the Ranch from the site. Thus, we are back to the parking area at the Ranch headquarters between 4:15 and 4:30pm.

TAP Field School Information

Background

The field school is conducted on the B-Square Ranch, a combination working cattle ranch, waterfowl conservation area, and museum facility. The field school is in a gorgeous location at the base of the Shannon Bluffs and adjacent to the San Juan River, overlooking Farmington lying immediately to the north. We are in high desert Colorado Plateau terrain and normally receive only eight inches of rain a year. Our area is called “Totah” by the local Navajos meaning “land amidst water” because of the three rivers which junction at the western edge of Farmington. This year we will be continuing to work in the Point Great Kiva and Great House, the Court Kiva in the plaza area, and the pitstructure.

2023 Class Information

Again, the dates for this year’s field school are June 5 to July 14, 2023. The field days of the class will run from 8:30 am to 4:30 pm. The first day of class, June 5th, and all lab days will run from 9 am to 5 pm. **A tentative schedule is attached at the end of the text in this document and before the map appendices.**

The first day of field school, June 5, 2023, we will meet at the San Juan College off-campus building where the lab is located, at **800 South Hutton Ave.** in Farmington. Starting at 9am, the first day will include introductions, an overview of the Totah Archaeological Project, review of fundamental concepts of archaeology and common archaeological terms, information on our local environment, an overview of Four Corners prehistory, an introduction to artifacts and features we expect to find, and general gridding and excavation procedures. We will eat lunch at our campus’s Mary’s Kitchen and take a quick tour of the campus at that time. If you need to save money, you are welcome to bring your lunch instead of buying food. We will caravan out to the B-Square Ranch

on Tuesday, June 6th, when we may be able to meet Tommy Bolack. If not, he may come out later in the session. The rest of that day will be spent touring the Ranch viewing several archaeological sites including several rock art panels. Excavation will begin at Point Pueblo on Wednesday, June 7th. We will bring our equipment out on Wednesday June 7th, set up, arrange dig crews, hand out dig crates, and begin excavation! The porta-pottie arrives that day also.

In general, we are excavating three or four days a week during the four-week field session. Students are put into two person crews and assigned a dig box with equipment such as trowels, picks, brushes, items necessary for keeping your forms and organizing artifacts, and an excavation manual. The course also includes two days of archaeological survey on the Ranch. We will survey, find a site, pinflag it out, and record it. We will go over site recording techniques including use of both GPS and compass/tape. Laboratory days during the field session will include washing and cataloging collected excavation artifacts, as well as listening to lectures on several archaeological topics such as Southwest archaeology, ceramic and lithic analysis, and contract archaeology processes and procedures. Field trips (optional) are planned to include Mesa Verde, Salmon Ruins, Aztec Ruins, Navajo pueblitos in Largo Canyon, and Chaco Canyon National Historic Park, as well as the South Gap trip mentioned above.

The two weeks of lab work from July 3 to July 14, 2023 will be comprised of finishing washing and bagging artifacts and samples, organizing the boxes of artifacts and samples, entering artifact and provenience data into spreadsheets, editing of that data, production of tables of the provenienced artifact data, drafting of figures, scanning excavation forms, organization of forms within the logbook, and photography of decorated ceramics, diagnostics, and exotic item, and finally verbal portions of the report will be produced from excavation forms. As these tasks are completed, the materials will be provided to students taking the class for a grade, along with instructions for completing the report and existing report examples. Materials will be provided to the students still in Farmington or emailed to those who have completed their attendance requirements and left Farmington. Lab and report preparation experience is vital for students who want to continue in the field of archaeology, thus it is recommended that this portion of the class is quite important for those students. Previous students have been invaluable for getting these organizational tasks completed and it is excellent experience to be added to your vitae

Although not required, we strongly encourage you to keep a journal. You will be allowed to write in it any time during the day. You will each be given a standard Composition Book to use as a journal, but if you want a nicer journal, bring your own. You will want to bring a camera!

Summary of Previous SJC Field School Work at Point

The Point Great House was originally recorded in 1963 during survey of canal routes for the Navajo Reservoir Project. The site is located on a small river terrace overlooking the San Juan River to the north beneath an imposing V-shaped cliff face of the Shannon Bluffs which form the southern boundary of the site. Surface features noted prior to excavation included a large depression representing a great kiva, roomblock masonry rubble extending eastward from the great kiva for about 90m, a depression representing a pithouse or kiva, and an extensive midden covering the eastern slope of the site.

SJC field school excavations began at the Point site in 2006. A True North-South and East-West metric grid was established on the site from a main datum set at 100m North and 100m East in the southwestern corner of the site. Work conducted each year is summarized below:

- 2006 Excavated area northeast of the great kiva depression finding several masonry walls.
- 2007 Extended the 2006 excavation eastward and discovered additional walls resulting in partial excavation of one large room containing several floor features.

- 2008 Excavation on the south side of the great kiva depression where the great kiva antechamber was discovered.
- 2009 Excavation began on a north-south trench placed through the center of the great kiva resulting in discovery of the northern great kiva bench.
- 2010 Completed excavation of the north-south trench through the great kiva and exploration began in the area north of the great kiva where more great house room walls were revealed.
- 2011 Completed excavation of an east-west trench through the center of the great kiva and both the eastern and western edges of the great kiva were found. Walls representing two rooms were found in the area southeast of the great kiva and two units were excavated into midden.
- 2012 After backhoe removal of fill from the north half of the great kiva, excavation was completed of the uppermost floor and discovered roof support platform features.
- 2013 After backhoe removal of fill from the south half of the great kiva, excavation began on that portion of the uppermost floor and roof support platform features.
- 2014 Excavation continued on the southern great kiva floor, a small kiva was found while testing a central portion of the great house roomblock, and another kiva was found while testing an area immediately west of the great kiva.
- 2015 Excavation of the uppermost floor in the great kiva was finalized and a north-south 1m wide trench was excavated through the middle of the great kiva down to the original floor revealing a lower remodeled floor and the original floor.
- 2016 Excavation of about $\frac{3}{4}$ of the remodeled floor in the east half of the great kiva revealing numerous floor features.
- 2017 Excavation of great house walls and two rooms of the 7-room small house that was discovered between two segments of the great house and testing of two small kivas.
- 2018 Excavation of 9 rooms in a roomblock arc that was discovered on the south side of the great house roomblock rubble. Excavation of the remodeled floor on the east half of the great kiva was finalized resulting in discovery of more anomalous features in the east half of the great kiva.
- 2019 Excavation of four of the great house rooms, testing of a pitstructure/kiva depression, and discovery of a previous great kiva beneath the upper great kiva.
- 2020 Field school cancelled due to COVID-19.
- 2021 Excavation continued in four great house rooms, the pitstructure depression, and the lower floors of the great kiva. Excavation began on the newly discovered plaza kiva and two rooms of the newly discovered Mesa Verde Small House Unit 2. Testing was conducted in the eastern midden area and an area on the east side of the great house.
- 2022 Excavation continued with units in search of Floors 4 and 5 of the western portion of the lower Great Kiva, units in the pitstructure depression, units in the Great House Court Kiva, units at the northeastern end of the arc of rooms, and units in several rooms of the Great House.
- 2023 Proposed excavation will continue in the pitstructure depression, the Great Kiva, the Court Kiva, and the Great House.

San Juan College Policies

Overview

San Juan College Policies can be found at:

<https://catalog.sanjuancollege.edu/content.php?catoid=6&navoid=264> as well as the student handbook <https://www.sanjuancollege.edu/studenthandbook/>. These documents will provide students answers to any rules and regulations outlined by the college.

Coronavirus Policy

<https://www.sanjuancollege.edu/coronavirus/>

As a response to New Mexico Governor Michelle Lujan Grisham's most recent public health order, San Juan College does not require masks be worn on campus. While the vaccine is encouraged, San Juan College does not require students to show proof of vaccination. San Juan College will continue to monitor guidance from the CDC and the New Mexico Department of Health and will update requirements as that guidance evolves and as conditions warrant. Please see the following web page for further information:

Disabilities Policy

https://catalog.sanjuancollege.edu/content.php?catoid=6&navoid=264#Americans_With_Disabilities_Act

Students requiring additional accommodations or considerations please visit our disabilities policy website. San Juan College states: There may be health and safety conditions which require notification to school officials, and specifically, any conditions that may affect the health and safety of the student or of others. These conditions, although they may be reflective of disabilities, may be disclosed to school officials with legitimate educational interests.

A student with a disability may request in writing that his/her disability not be disclosed to other school officials. The disabled student will make the request in writing to the coordinator of Disability Services. The coordinator, and the faculty advisor, will review the request for the non-disclosure of the disability. If the coordinator deems that the disability does not pose a health or safety problem, and that there is not a risk of violations of the Americans with Disabilities Act, then the request of the student may be honored. The review is done separately for each individual course in which the student enrolls. Unless the request for non-disclosure is approved, the coordinator of Disability Services will advise appropriate school officials of the disability and of any necessary accommodations for the student.

Records for a student that are made or maintained by a psychotherapist for the purpose of diagnosis or treatment of the student are available to the person providing the diagnosis or treatment and to others as authorized by the student, or by court order. For purposes of this policy, a psychotherapist is:

1. a person authorized to practice medicine, engaged in the diagnosis or treatment of a mental or emotional condition, and
2. a person licensed or certified as a psychologist and similarly engaged.

Counseling records are subject to disclosure to school officials with a legitimate education interest.

Anti-Harassment and Discrimination Policy

<https://www.sanjuancollege.edu/titleix/>

San Juan College is committed to creating and maintaining an environment free of discrimination. In support, the Totah Archaeological Project Field School and Internship prohibit discrimination, including harassment and retaliation, based on a protected classification, including race, color, religion, sex, national origin, age, disability, veteran status, sexual orientation, gender identity, or genetic information. The Totah Archaeological Project encourages anyone who believes they have been the subject of discrimination to report the matter immediately as described on the college's web page.

All members of the Field School are responsible for helping to create a project environment free from all forms of prohibited discrimination and for cooperating with San Juan College Title IX officials who investigate allegations of policy violations. We will discuss the policy with students and require students to read the sexual harassment policy and sign off on it, keeping a copy with the pertinent information for contacting SJC Title IX personnel.

Final Notes

Thanks so much for your interest! I have had hard-working and passionate students for many years now and am looking forward to the 2023 group! The archaeological work is physically demanding, but fun and interesting because of working within architecture and the recovery of gorgeous Southwestern pottery, a wide variety of lithic debitage and tools, and exotic decorative items. Several students have used materials and information from the site for their theses. Please ask about this if you are interested. We are looking forward to the summer and hope you can join us! The most recent maps of the entire site and details of the great house and great kiva are attached below after the proposed 2023 Summer Session Calendar. **Feel free to contact me with any questions you might have.** I will update all interested students occasionally and provide additional information in early April just before registration begins. Students will also be updated occasionally as registration proceeds.

Linda Wheelbarger, Adjunct Faculty and Director of Totah Archaeological Project
San Juan College, 4601 College Blvd., Farmington, NM 87402
wheelbarger@sanjuancollege.edu 505 320-1834

San Juan College – TAP 2023 Field School Schedule
ANTH 2120 - Archaeological Field Methods (Field School) and
ANTH 2998 Archaeology Internship
May 23 to July 8, 2022; A 6-Week Session

Totah Archaeological Project Field School Schedule						
May-August 2023						
Sunday	Monday	Tuesday	Wednesday	Thursday	Friday	Saturday
May 28	May 29 Prep Week	May 30 Prep	May 31 Prep	June 1 Prep	June 2 Prep	June 3
June 4	June 5 Class Day	June 6 Ranch Tour	June 7 Excavation	June 8 Excavation	June 9 Excavation	June 10
June 11	June 12 Excavation	June 13 Excavation	June 14 Excavation	June 15 Excavation	June 16 Salmon Tour/ Lab	June 17
June 18	June 19 Excavation	June 20 Excavation	June 21 Excavation	June 22 Ranch Survey	June 23 Excavation	June 24
June 25	June 26 Excavation	June 27 Excavation	June 28 Excavation	June 29 Excavation	June 30 Aztec Tour/Lab	July 1
July 2	July 3 Lab	July 4 Lab	July 5 Ranch Survey	July 6 Lab	July 7 Lab	July 8
July 9	July 10 Lab	July 11 Lab	July 12 Excavation	July 13 Lab	July 14 Lab	July 15
July 16	July 17	July 18	July 19	July 20	July 21 Report Info to Students	July 22
July 23	June 24	June 25	June 26	June 27	June 28	June 29
June 30	June 31	July 1	July 2	July 3	July 4 Preliminary Report Due	July 5
July 6	July 7	July 8	July 9	July 10	July 11	July 15
July 16	July 17	July 18	July 19	July 20	July 21	July 22
July 23	July 24	July 25	July 26	July 27	July 28	July 29
July 30	July 31	August 1	August 2	August 3	August 4 Final Report Due	August 5
August 6	August 7	August 8	August 9	August 10	August 11	August 12
August 13	August 14 Grades Due	August 15	August 16	August 17	August 18	August 19

Appendix 1: 2022 Point Site Map

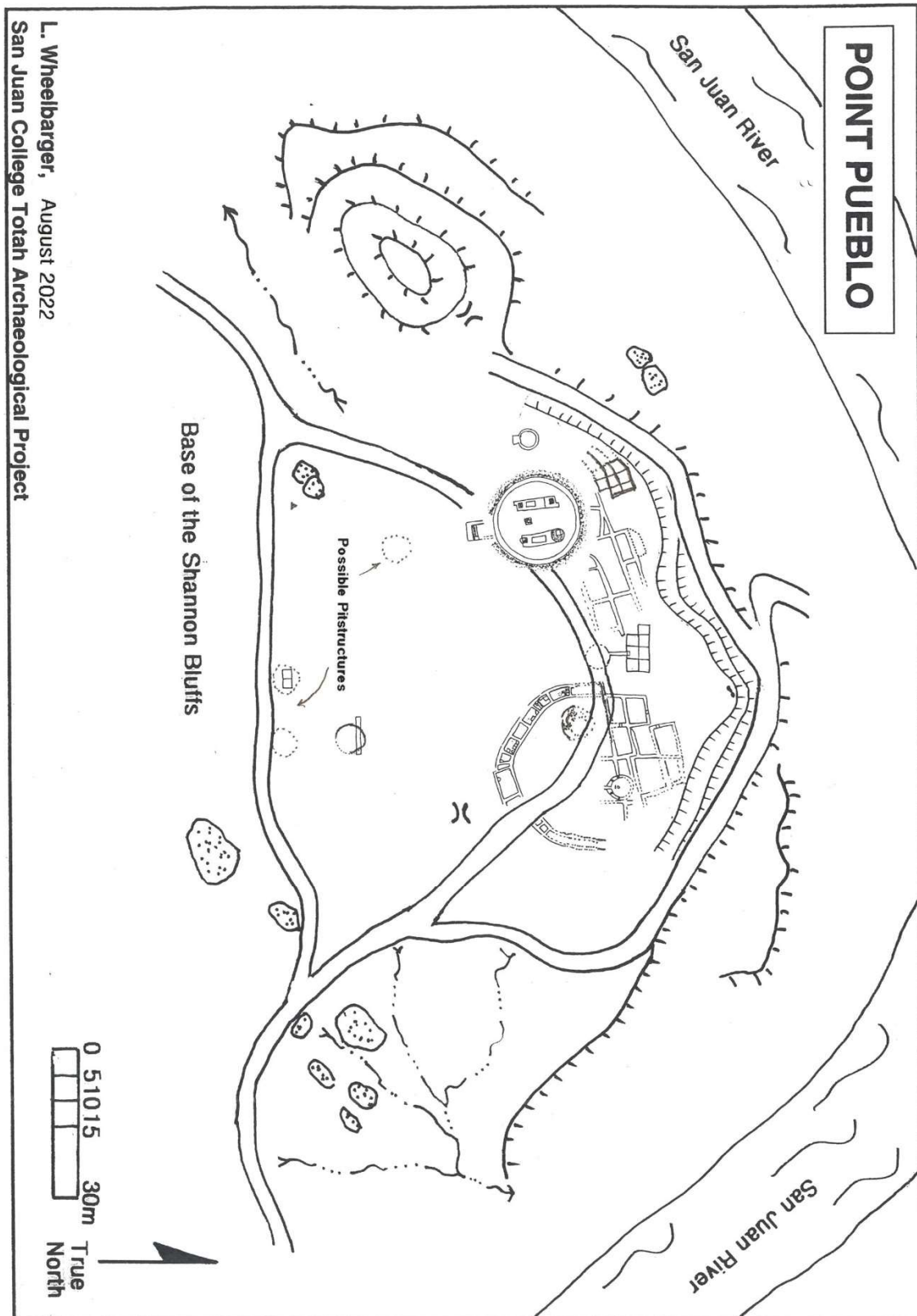

Appendix 2: 2022 Point Great House Map

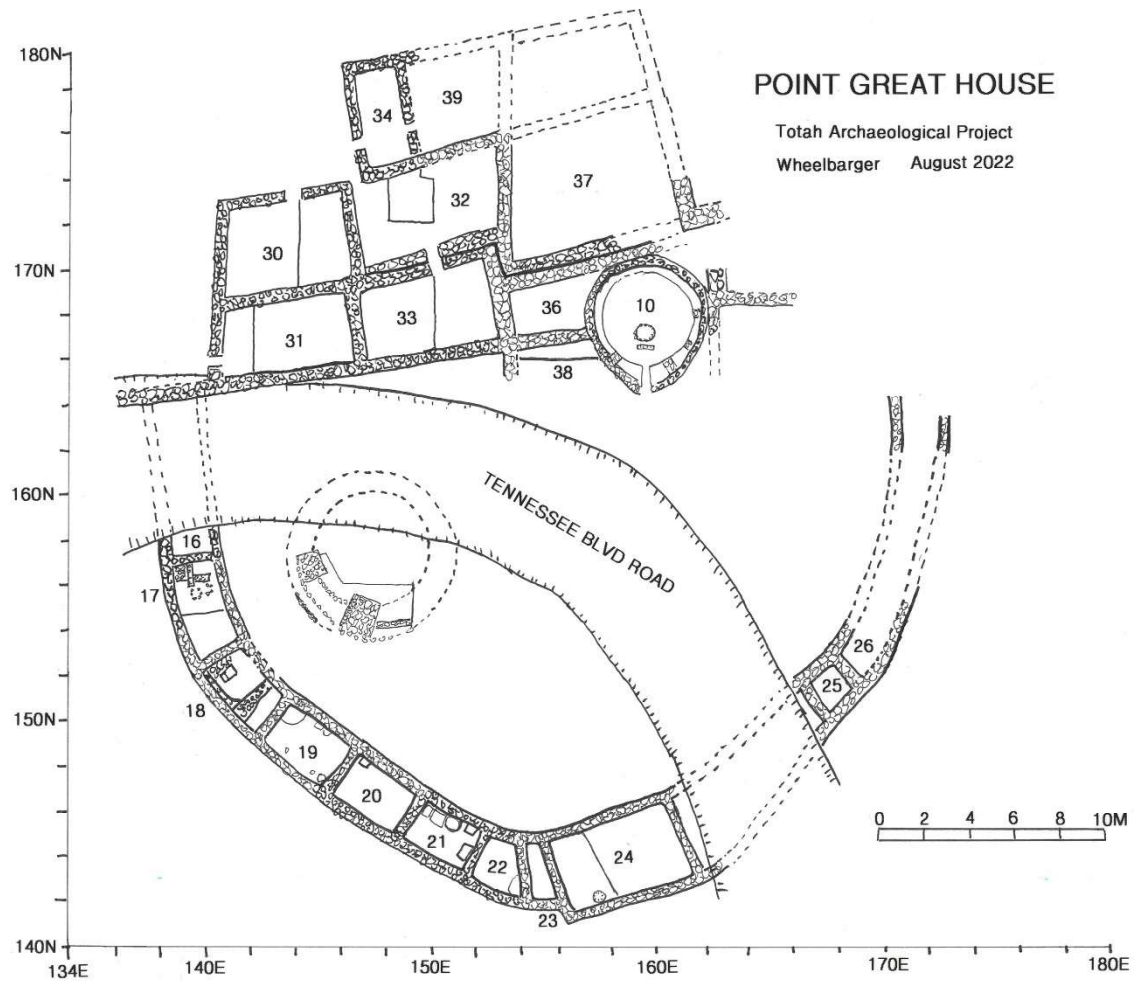

Appendix 3: 2022 Point Great Kiva Map, Upper and Lower

